

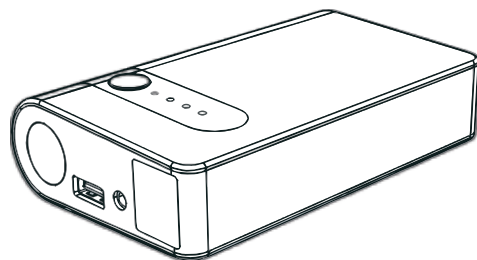

## Vehicle Jump Starter and Handheld Device Charger



### User's Guide

- Jump start a vehicle (gasoline powered), motorcycle, boat, etc.
- Charge mobile phone, tablet, camera, portable music or gaming device, etc.
- LED light with 3 modes of illumination.

#### PARTS LIST

#	Part name	Quantity	#	Part name	Quantity
1	Jump starter	1	4	Car Adapter	1
2	Phone/Tablet Charging Cable	1	5	Jump-starting Cables	1
3	Wall Adapter	1	6	User Manual	1

#### TECHNICAL SPECIFICATIONS

Size: 131x75x25mm / 5.16x2.95x0.98in
Weight:300g
Battery capacity:8000mAh
Output: USB 2.0 5V $\overline{\text{---}}$ 2A;12V for car jump starter
Input:12V $\overline{\text{---}}$ 1A
Full charging time: 3 hours
Starting current:200A
Peak current:400A
Operating temperature:0°C-60°C

#### OPERATION GUIDE

##### LED Illumination

Press the power button for 3 seconds to start the LED solid light illumination. Continue to press the power button for 1 second each to scroll through the additional modes (Strobe, SOS).

##### Charging Mobile Phone/Tablet/Camera/Portable Music or Gaming Device, etc.

1. Plug the mobile phone/tablet cable into the USB 5V/2A output port.
2. Select the appropriate connector for your device and connect it to your mobile phone, tablet, portable music or gaming device, etc. The MiniMax™ Charger will identify and charge the electronic device automatically. The indicator lights will be on when charging.

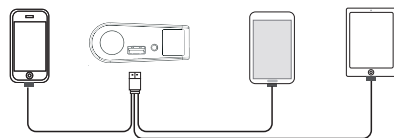

#### Charging the MiniMax™ unit:

1. Plug the home adaptor into the universal socket.
2. Connect the 12V/1A input port of the MiniMax™ unit to the other end of the home adaptor.

OR

1. Plug the car adaptor into the socket of cigarette lighter.
2. Connect the 12V/1A input port of the MiniMax™ unit to the other end of the car adaptor.

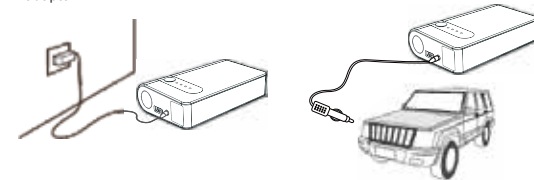

#### TO JUMP START A 12V VEHICLE BATTERY

Ensure that at least 3 of the indicator lights on the MiniMax™ unit are on.

1. Connect the Red (+) battery clamp of jumper cable to the vehicle's positive (+) battery terminal and connect the Black (-) battery clamp of jumper cable to the vehicle's negative (-) battery terminal.
2. Plug the cord of the jumper cable into the jump starter socket on the MiniMax™ unit.
3. Start the vehicle.
4. When the vehicle starts, remove the jumper cable from the MiniMax™ unit within 30 seconds.
5. Disconnect the Red and Black clamps from the vehicle battery terminals.

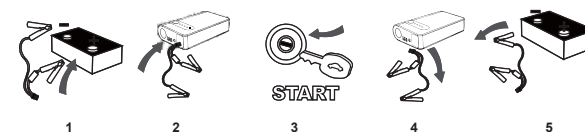

#### Indicator Lights

Press the power button to check the capacity of the MiniMax™ Jump Starter/Charger:

Indicator lights	1 flashing	1 solid	2 solid	3 solid	4 solid
Battery capacity	0%	25%	50%	75%	100%

When charging, indicator lights will flash one by one. The number of solid indicator lights indicates the battery capacity of this product. Full indicator lights are solid when charging is paused or completed.

#### PRODUCT LAYOUT

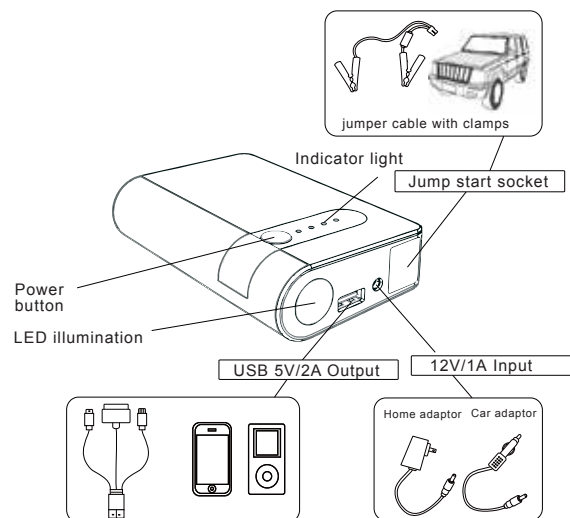

#### FAQ

- Q. How do you turn the MiniMax™ Jump Starter/Charger off?  
A. The device will turn off automatically when there is no activity or when charging is complete.
- Q. How many times can the fully charged MiniMax™ unit be used to jump start an automobile?  
A. The MiniMax™ unit can jump start an automobile approximately ten times before needing to be re-charged.
- Q. How many times can the MiniMax™ unit be used to charge my mobile phone before needing to be re-charged?  
A. The MiniMax™ Jump Starter/Charger can fully charge mobile phones about four times before the unit needs to be recharged.
- Q. How long will it take to fully charge my mobile phone using the MiniMax™ unit?  
A. It takes approximately 90 minutes to fully charge a mobile phone.
- Q. For how many months will the MiniMax™ unit hold a charge without recharging?  
A. The MiniMax™ unit can hold a charge capable of starting an automobile for up to one year. However, we strongly suggest recharging the MiniMax™ unit every six months to ensure it is fully charged and ready to use when the need arises.

#### SAFETY AND PRECAUTIONS

1. In order for the MiniMax™ unit to work properly, insert the blue socket end of the jumper cable cord firmly into the MiniMax™ unit. Failure to properly insert the blue socket into the MiniMax™ unit will result in the unsuccessful jump start of the vehicle and could also melt the cables where they are improperly connected.
2. Before trying to jump start a vehicle, be certain that the cable clamps are properly connected to the battery terminals/ports. Ensure the terminals/ports are clean prior to connecting the cables, to ensure better electrical conductivity.
3. If after three jump start attempts with the MiniMax™ unit, the vehicle does not start, please stop using the device, as it can be damaged. A professional mechanic should be consulted to look for other problems with the vehicle.
4. Never connect the Red or positive clamp to the Black or negative clamp, as serious injury may occur.
5. Disconnect the MiniMax™ unit from the vehicle within 30 seconds after jump starting successfully. Failure to do so could result in serious injury or accident.
6. Never attempt to disassemble the battery or any of its components, as serious injury or accident may occur.
7. Always remember that despite its small size, the MiniMax™ unit is a powerful electrical device and should always be handled carefully only by adults who have read this User's Guide and understand the warnings.

#### WARNINGS

1. Always be very careful when handling the MiniMax™ unit.
2. Never allow the MiniMax™ unit to be used by children. Always keep the MiniMax™ unit out of the reach of children.
3. The MiniMax™ unit should not be used by persons with reduced physical, sensory or mental capabilities.
4. The MiniMax™ Jump Starter/Charger is not a toy. This device is only intended for use as a jump starting tool or power bank.
5. To avoid danger of suffocation or any other hazards, do not leave packaging (such as plastic bags, polystyrene, etc.) within reach of children.
6. Do not allow the MiniMax™ unit to become wet.
7. Never immerse the MiniMax™ unit in water or other liquids or chemicals.
8. Never use the MiniMax™ unit near explosive or flammable chemicals or materials.
9. Never attempt to disassemble or modify the MiniMax™ unit or any of its components.
10. Do not expose the MiniMax™ unit or any of its components to extreme heat.
11. Do not store the MiniMax™ unit in temperatures above 35C/95F degrees or below -12C/10F degrees.
12. Only charge the MiniMax™ unit using the wall adaptor and car adaptor provided. No other adaptors should be used.
13. Only charge the MiniMax™ unit at ambient temperatures between 0°Celsius or 32° Fahrenheit and 60° Celsius or 140° Fahrenheit.
14. Under very extreme conditions, battery leakage may occur. Using caution, wipe off the liquid on the battery using a clean, dry cloth. Be very careful to avoid contact with the skin or eyes. Should contact occur with the liquid, rinse immediately with clean water and seek immediate medical attention.
15. The manufacturer and distributor are not responsible for any damage caused by the MiniMax™ Jump Starter/Charger due to incorrect use.
16. When the MiniMax™ unit has reached the end of its useful life, please dispose of it in an environmentally friendly way in accordance with applicable laws.

FC CE RoHS



Overcharge and  
Overdischarge Protection



Fuse Protection



Distributed by  
Thane Canada Inc., Mississauga ON L4W 5M6, Canada  
Thane Direct UK Ltd, London WC2A 3LH, UK  
Operadora Ainoa, S.A.P.I. DE C.V., C.P 02480, México. D.F.  
TVINS. 211 18 Malmö, Sweden

© 2015 Thane IP Limited & Harrington Multi Media Marketing

MinMax™ MNL ENG R0 151120